

Retail Design Services

EXPERIENCE INNOVATION
REPUTATION



PORTAGE CENTER PLAZA
PORTAGE, MI

Architectural design services for a new 25,000-square-foot multi-use office and retail facility.



MARTIN'S SUPERMARKET
ST. JOSEPH, MI

Provided site design services for a 56,200-square-foot supermarket and two 6,000 square-foot out-lot buildings. The site design required 20-foot cuts in the property, a difficult-to-handle combination of clay and sandy soils and a 56,000-cubic-foot underground stormwater detention system, all on a compact four-acre site.

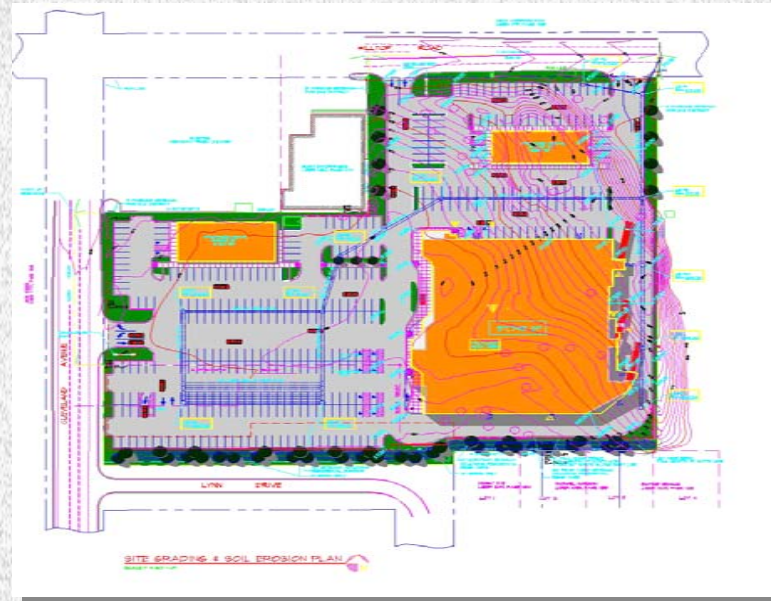

Wightman & Associates, Inc.
2303 Pipestone Road
Benton Harbor, MI 49022
Ph: (269) 927-0100
Fx: (269) 927-1300
www.wightman-assoc.com

Wightman Environmental, Inc.
4050 King Dr., P.O. Box 95
Sodus, Michigan 49126
(269) 934-7707

Wightman Ward, Inc.
9835 Portage Road
Portage Michigan 49002
(269) 327-3532

Wightman Petrie, Inc.
4703 Chester Drive
Elkhart, Indiana 46515
(219) 293-7762

Wightman Petrie Environmental, Inc.
Wightman Petrie, Inc.
713 S. Scott Street
South Bend, Indiana 46601
(574) 232-4388

Wightman Jones, Inc.
114 Chestnut Street
Allegan, Michigan 49010

Wightman & Associates, Inc.
ENGINEERING ♦ SURVEYING ♦ ARCHITECTURE



**BANNER BOOKS
ST. JOSEPH, MI**

Front façade renovation
and showroom expansion.



**NEW CHILI'S RESTAURANT
NORTON SHORES, MI**

**NEW STRIP MALLS
ST. JOSEPH, MI**



Site design for a new strip mall and bank. Also provide architectural design services for all retail space.



**WALGREEN'S COMMERCIAL CENTER
ST. JOSEPH, MI**

Site design of a 74-acre retail/residential site including three retail buildings, one of which was leased to Walgreens, and a 21-lot subdivision.



**POKORNY BUILDING
NEW BUFFALO, MI**

Architectural design services for a multi-use, multi-unit facility. The first floor was converted into six retail shops. A second floor residence of approximately 2,100 square feet was added for a total building area of 11,000 square feet.

